

Datasheet

Type: NS57
Itemnr.: 5700170830003

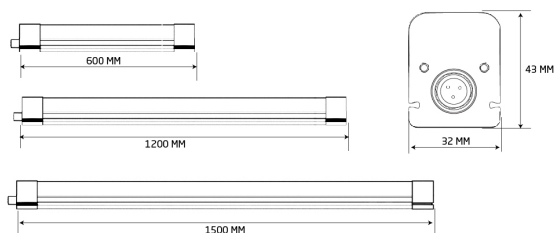
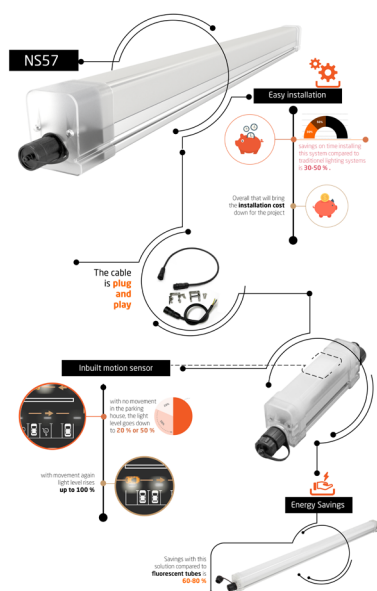

Lumega Europe ApS
Phone +4571995825
info@lumega.eu
www.lumega.eu

Technical Data

Lumen	2.520lm, 2.800lm, 4.200lm or 4.900lm
Beam Angle	120
Colors Available	Warm white, Neutral white, Cold white
Color Temperature	3000K, 4000K, 5000K, 6000K
Color Rendering	CRI80 (Option CRI90)
MacAdam	Step 3
Consumption	18W, 20W, 30W or 35W
Voltage Range	220 ~ 240VAC 50/60Hz
Current LEDs	350mA - 700mA
PF Power Factor	>95 @ Full load
Flicker	<1 % Flicker free (IEEE Std. 1789-2015)
10A Fuse Type C	Max. 28 luminaires (Start Current limit)
Leakage current	< 0,5mA @ 240V AC
Efficiency	140 lm/W (LEDs 220 lm/W)
Equal To	NS57 20W = Fluorescent tube T8 36W
Lifetime TM-21	60K hours at Ta = 25°C (L80) B10
Lifetime LEDs	100K hours at Ta = 25°C (L80) B50
Lifetime driver	100K hours at Ta = 25°C (MTBF) B50
Driver Options	1-10V or Motion Sensor
IP Code	IP65
IK Class	IK05 (Option IK08)
Class	2, Double Insulated
Working temp	-30 to 50 degree Celsius
Size	W32 x H43 x L600, 1200 or 1500 mm
Wire length	1.2 or 3.0 meter
Installation	Surface mounted or Pendant installation
Linkable cables	Yes, plug in each end (only Lumega cables)
Material used	Die cast aluminum, PMMA for frontglass
Weight	1,3 Kg - 1.7 Kg
Shipping	Package of 12 - 24 pcs
IES File	Yes
Certificates	CE, ROHS, TM21, LM80, IES
Warranty	5 years*
Housing	White or optional
Included	Complete lamp housing, LEDs, driver

